

Department of Public Safety
Division



Liquor Licensing & Inspection

Promise by any person that he or she can expedite a liquor license through influence should be completely disregarded. To avoid possible financial loss an applicant, or prospective applicant, should consult with the Division before making any substantial investment in an establishment that now is, or may be, attended by a liquor license.

<u>BUREAU USE ONLY</u>	
License No. Assigned:	
Class:	
Deposit Date:	
Amt. Deposited:	

PRESENT LICENSE EXPIRES 12/31/10

INDICATE TYPE OF PRIVILEGE: MALT SPIRITUOUS VINOUS

INDICATE TYPE OF LICENSE:

- | | |
|---|---|
| <input type="checkbox"/> RESTAURANT (Class I,II,III,IV) | <input type="checkbox"/> RESTAURANT/LOUNGE (Class XI) |
| <input type="checkbox"/> HOTEL-OPTINONAL FOOD (Class I-A) | <input type="checkbox"/> HOTEL (Class I,II,III,IV) |
| <input type="checkbox"/> CLASS A LOUNGE (Class X) | <input type="checkbox"/> CLUB-ON PREMISE CATERING (Class I) |
| <input type="checkbox"/> CLUB (Class V) | <input checked="" type="checkbox"/> GOLF CLUB (Class I,II,III,IV) |
| <input type="checkbox"/> TAVERN (Class IV) | <input type="checkbox"/> OTHER: _____ |

REFER TO PAGE 3 FOR FEE SCHEDULE

ALL QUESTIONS MUST BE ANSWERED IN FULL

1. APPLICANT(S) (Sole Proprietor, Corporation, Limited Liability Co., etc.)	2. Business Name (D/B/A)
DOB:	<u>Purpodock Club</u>
<u>Purpodock Club</u>	DOB:
DOB:	Location (Street Address)
DOB:	<u>300 Spurwink Avenue</u>
Address	City/Town State Zip Code
<u>300 Spurwink Avenue</u>	<u>Cape Elizabeth, ME 04107</u>
<u>Cape Elizabeth, ME 04107</u>	Mailing Address
City/Town State Zip Code	(Same as above)
<u>(207) 799-2273 (207) 799-2701</u>	City/Town State Zip Code
Telephone Number Fax Number	Business Telephone Number Fax Number
<u>01-0145780</u>	<u>(207) 799-2273 (207) 799-2701</u>
Federal I.D. #	Seller Certificate # <u>2080</u>

3. If premises are a hotel, indicate number of rooms available for transient guests: 0
4. State amount of gross income from period of last license: ROOMS \$ 0 FOOD \$ 493,500 LIQUOR \$ 291,000
5. Is applicant a corporation, limited liability company or limited partnership? YES NO

complete Supplementary Questionnaire, If YES

6. Do you permit dancing or entertainment on the licensed premises? YES NO
7. If manager is to be employed, give name: Robyn Violette
8. If business is NEW or under new ownership, indicate starting date: _____
- Requested inspection date: _____ Business hours: _____
9. Business records are located at: 300 Spurwink Avenue Cape Elizabeth, ME. 04107
10. Is/are applicants(s) citizens of the United States? YES NO

11. Is/are applicant(s) residents of the State of Maine? YES NO

12. List name, date of birth, and place of birth for all applicants, managers, and bar managers. Give maiden name, if married:
Use a separate sheet of paper if necessary.

Name in Full (Print Clearly)	DOB	Place of Birth
Daniel Redmond	10/16/1946	Boston, MA
James O'Connor	2/10/1958	Trenton, NJ
Robin Violette	1/8/1968	Portland, Me.

Residence address on all of the above for previous 5 years (Limit answer to city & state)

Daniel Redmond: 24 Heron Point, Cape Elizabeth, Me 04107
 James O'Connor: 548 Ocean House Rd, South Portland, Me 04106
 Robin Violette: 95 Bradley Street, Portland, Me 04102

13. Has/have applicant(s) or manager ever been convicted of any violation of the law, other than minor traffic violations, of any State of the United States? YES NO

Name: _____ Date of Conviction: _____
 Offense: _____ Location: _____
 Disposition: _____

14. Will any law enforcement official benefit financially either directly or indirectly in your license, if issued?
Yes No If Yes, give name: _____

15. Has/have applicant(s) formerly held a Maine liquor license? YES NO

16. Does/do applicant(s) own the premises? Yes No If No give name and address of owner:
Furpoosack Club 300 Spawville Ave, Cape Elizabeth, Me 04107

17. Describe in detail the premises to be licensed: (Supplemental Diagram Required) (2) Dining rooms, bar, banquet room, deck, locker rooms

18. Does/do applicant(s) have all the necessary permits required by the State Department of Human Services?
YES NO Applied for: _____

19. What is the distance from the premises to the NEAREST school, school dormitory, church, chapel or parish house, measured from the main entrance of the premises to the main entrance of the school, school dormitory, church, chapel or parish house by the ordinary course of travel? 2 miles Which of the above is nearest? School

20. Have you received any assistance financially or otherwise (including any mortgages) from any source other than yourself in the establishment of your business? YES NO

If YES, give details: _____

The Division of Liquor Licensing & Inspection is hereby authorized to obtain and examine all books, records and tax returns pertaining to the business, for which this liquor license is requested, and also such books, records and returns during the year in which any liquor license is in effect.

NOTE: "I understand that false statements made on this form are punishable by law. Knowingly supplying false information on this form is a Class D offense under the Criminal Code, punishable by confinement of up to one year or by monetary fine of up to \$2,000 or both."

Dated at: Cape Elizabeth, Maine on November 30, 20 10
Town/City, State Date

Daniel Redmond
Signature of Applicant or Corporate Officer(s)

Please sign in blue ink

James O'Connor
Signature of Applicant or Corporate Officer(s)

Print Name

Print Name

NOTICE – SPECIAL ATTENTION

All applications for NEW or RENEWAL liquor licenses must contact their Municipal Officials or the County Commissioners in unincorporated places for approval of their application for liquor licenses prior to submitting them to the bureau.

THIS APPROVAL EXPIRES IN 60 DAYS.

FEE SCHEDULE

Class I	Spirituos, Vinous and Malt	\$ 900.00
	CLASS I: Airlines; Civic Auditoriums; Class A Restaurants; Clubs with catering privileges; Dining Cars; Golf Clubs; Hotels; Indoor Ice Skating Clubs; Indoor Tennis Clubs; Vessels; Qualified Caterers; OTB.	
Class I-A	Spirituos, Vinous and Malt, Optional Food (Hotels Only)	\$1,100.00
	CLASS I-A: Hotels only that do not serve three meals a day.	
Class II	Spirituos Only	\$ 550.00
	CLASS II: Airlines; Civic Auditoriums; Class A Restaurants; Clubs with catering privileges; Dining Cars; Golf Clubs; Hotels; Indoor Ice Skating Clubs; Indoor Tennis Clubs; and Vessels.	
Class III	Vinous Only	\$ 220.00
	CLASS III: Airlines; Civic Auditoriums; Class A Restaurants; Clubs with catering privileges; Dining Cars; Golf Clubs; Hotels; Indoor Ice Skating Clubs; Indoor Tennis Clubs; Restaurants; Vessels; Pool Halls; and Bed and Breakfasts.	
Class IV	Malt Liquor Only	\$ 220.00
	CLASS IV: Airlines; Civic Auditoriums; Class A Restaurants; Clubs with catering privileges; Dining Cars; Golf Clubs; Hotels; Indoor Ice Skating Clubs; Indoor Tennis Clubs; Restaurants; Taverns; Pool Halls; and Bed and Breakfasts.	
Class V	Spirituos, Vinous and Malt (Clubs without Catering, Bed & Breakfasts)	\$ 495.00
	CLASS V: Clubs without catering privileges.	
Class X	Spirituos, Vinous and Malt – Class A Lounge	\$2,200.00
	CLASS X: Class A Lounge	
Class XI	Spirituos, Vinous and Malt – Restaurant Lounge	\$1,500.00
	CLASS XI: Restaurant/Lounge; and OTB.	

FILING FEE.....\$ 10.00

UNORGANIZED TERRITORIES \$10.00 filing fee shall be paid directly to County Treasurer. All applicants in unorganized territories shall submit along with their application evidence of payment to the County Treasurer.

All fees must accompany application, made payable to: **TREASURER, STATE OF MAINE. – DEPARTMENT OF PUBLIC SAFETY, LIQUOR LICENSING AND INSPECTION DIVISION, 164 STATE HOUSE STATION, AUGUSTA ME 04333-0164.** Payments by check subject to penalty provided by Sec. 3, Title 28A, MRS.

STATE OF MAINE

Dated at: _____, Maine _____ SS
City/Town (County)

On: _____
Date

The undersigned being: _____ Municipal Officers _____ County Commissioners of the
_____ City _____ Town _____ Plantation _____ Unincorporated Place of: _____, Maine

Hereby certify that we have given public notice on this application and held public hearing thereon as required by Section 653 Title 28A, Maine Revised Statutes and hereby approve said application.

THIS APPROVAL EXPIRES IN 60 DAYS

NOTICE – SPECIAL ATTENTION

§ 653. Hearings; bureau review; appeal

1. **Hearing.** The municipal officers or, in the case of unincorporated places, the county commissioners of the county in which the unincorporated place is located, shall hold a public hearing for the consideration of applications for new on-premise licenses and applications for transfer of location of existing on-premise licenses. The municipal officers or county commissioners may hold a public hearing for the consideration of requests for renewal of licenses, except that when an applicant has held a license for the prior 5 years and a complaint has not been filed against the applicant within that time, the applicant may request a waiver of the hearing.
 - A. The bureau shall prepare and supply application forms. [1993, c.730, §27(amd).]
 - B. The municipal officers or the county commissioners, as the case may be, shall provide public notice of any hearing held under this section by causing a notice, at the applicant's prepaid expense, stating the name and place of hearing, to appear on at least 3 consecutive days before the date of hearing in a daily newspaper having general circulation in the municipality where the premises are located or one week before the date of the hearing in a weekly newspaper having general circulation in the municipality where the premises are located. [1995, c.140, §4 (amd).]
 - C. If the municipal officers or the county commissioners, as the case may be, fail to take final action on an application for a new on-premise license, for transfer of the location of an existing on-premise license or for renewal of an on-premise license within 60 days of the filing of an application, the application is deemed approved and ready for action by the bureau. For purposes of this paragraph, the date of filing of the application is the date the application is received by the municipal officers or county commissioners. This paragraph applies to all applications pending before municipal officers or county commissioners as of the effective date of this paragraph as well as all applications filed on or after the effective date of this paragraph. This paragraph applies to an existing on-premise license that has been extended pending renewal. The municipal officers or the county commissioners shall take final action on an on-premise license that has been extended pending renewal with 120 days of the filing of the application. [1999, c589, §1 (amd).]
 2. **Findings.** In granting or denying an application, the municipal officers or the county commissioners shall indicate the reasons for their decision and provide a copy to the applicant. A license may be denied on one or more of the following grounds:
 - A. Conviction of the applicant of any Class A, Class B or Class c crime: [1987, c45, Pt.A§4 (new).]
 - B. Noncompliance of the licensed premises or its use with any local zoning ordinance or other land use ordinance not directly related to liquor control; [1987, c.45, Pt.A§4(new).]
 - C. Conditions of record such as waste disposal violations, health or safety violation or repeated parking or traffic violations on or in the vicinity of the licensed premises and caused by persons patronizing or employed by the licensed premises or other such conditions caused by persons patronizing or employed by the licensed premises that unreasonably disturb, interfere with or affect the ability of persons or businesses residing or located in the vicinity of the licensed premises to use their property in a reasonable manner; [1993, c.730, §27 (amd).]
 - D. Repeated incidents of record of breaches of the peace, disorderly conduct, vandalism or other violations of law on or in the vicinity of the licensed premises and caused by persons patronizing or employed by the licensed premises; [1989, c.592,§3 (amd).]
 - E. A violation of any provision of this Title; and [1989, c.592, §3 (amd).]
 - F. A determination by the municipal officers or county commissioners that the purpose of the application is to circumvent the provisions of section 601. [1989, c.592, §4 (new).]
- [1993, c730, §27 (amd).]
3. **Appeal to bureau.** Any applicant aggrieved by the decision of the municipal officers or county commissioners under this section may appeal to the bureau within 15 days of the receipt of the written decision of the municipal officers or county commissioners. The bureau shall hold a public hearing in the city, town or unincorporated place where the premises are situated. In acting on such an appeal, the bureau may consider all licensure requirements and findings referred to in subsection 2.
 - A. [1993, c.730, §27 (rp).]
 4. **No license to person who moved to obtain a license. (REPEALED)**
 5. **(TEXT EFFECTIVE 3/15/01) Appeal to District Court.** Any person or governmental entity aggrieved by a bureau decision under this section may appeal the decision to the District Court within 30 days of receipt. Upon resolution of the appeal, if an applicant's license renewal is denied, the bureau shall refund the applicant the prorated amount of the unused license fee.

STATE OF MAINE
Liquor Licensing & Inspection Unit
164 State House Station
Augusta, Maine 04333-0164
Tel: (207) 624-7220 Fax: (207) 287-3424

SUPPLEMENTARY QUESTIONNAIRE FOR CORPORATE APPLICANTS, LIMITED LIABILITY COMPANIES AND LIMITED PARTNERSHIPS

1. Exact Corporate Name: Purpoodock Club
Business D/B/A Name: _____
2. Date of Incorporation: 1922
3. State in which you are incorporated: Maine
4. If not a Maine Corporation, date corporation was authorized to transact business within the State of Maine:

5. List the name and addresses for previous 5 years, birth dates, titles of officers, directors and list percent of stock owned:

Name	Address Previous 5 Years	Birth Date	% of Stock	Title
Daniel Redmond	24 Hemp Pt Rd, Cape Elizabeth, Me	10/16/46	0	President
Susan Abraham	35 Chase Street, So Port, Me.	10/25/59	0	Vice President
James O'Connor	548 Ocean House Rd, CE, Me	2/10/58	0	Treasurer
	* Non-profit corporation			

6. What is the amount of authorized stock? 0 Outstanding Stock? 0
7. Is any principal officer of the corporation a law enforcement official? () YES (X) NO
8. Has applicant(s) or manager ever been convicted of any violation of the law, other than a minor traffic violation(s), of the United States? () YES (X) NO.
9. If yes, please complete the following: Name: _____

Date of Conviction: _____ Offense: _____

Location: _____ Disposition: _____

Dated at: Cape Elizabeth, Maine On: December 1, 2010
City/Town Date

Daniel S. Redmond Date: 12/1/2010
Signature of Duly Authorized Officer

Daniel S. Redmond
Print Name of Duly Authorized Officer

MAINE DEPT OF PUBLIC SAFETY

STATE OF MAINE
Liquor Licensing & Inspection Division
164 State House Station
Augusta ME 04333-0164
Tel: (207) 624-7220 Fax: (207) 287-3424



SUPPLEMENTARY QUESTIONNAIRE FOR CORPORATE APPLICANTS, LIMITED LIABILITY COMPANIES, AND LIMITED PARTNERSHIPS

- Exact Corporate Name: Purpoadock Club
Business D/B/A Name: _____
- Date of Incorporation: 1922
- State in which you are incorporated: Maine
- If not a Maine Corporation, date corporation was authorized to transact business within the State of Maine: _____
- List the name and addresses for previous 5 years, birth dates, titles of officers, directors and list the percent of stock owned:

Name	<i>Print Clearly</i> Address Previous 5 years	Birth Date	% of Stock	Title
Daniel Redmond		10/16/1946	0	PRES.
Susan Abraham		10/25/1959	0	V. PRES.
James O'Connor		2/10/1958	0	TREASURER

- What is the amount of authorized stock? _____ Outstanding Stock? _____
- Is any principal officer of the corporation a law enforcement official? Yes No
- Has applicant(s) or manager ever been convicted of any violation of the law, other than minor traffic violations, of the United States? Yes No
- If YES, please complete the following: Name: _____
Date of Conviction: _____ Offense: _____
Location: _____ Disposition: _____
Dated at: _____ City/Town _____ On: _____ Date _____

Daniel S Redmond
Signature of Duly Authorized Officer
Daniel S. Redmond
Print Name of Duly Authorized Officer

12/1/10
Date

STATE OF MAINE
Liquor Licensing & Inspection Unit
164 State House Station
Augusta, Maine 04333-0164
Tel: (207) 624-7220 Fax: (207) 287-3424

SUPPLEMENTARY QUESTIONNAIRE FOR CLUB APPLICANTS

1. Exact Club Name: Purpoodeck Club

2. Title, name, birth date and telephone number of each principal officer of the club:

Title	Name	Birth Date	Telephone #
President	Daniel Redmond	10/16/1946	(207) 767-4198
Vice-President	Susan Abraham	10/25/1959	(207) 799-7640
Treasurer	James O'Connor	2/10/1958	(207) 799-9071

3. Date Club was incorporated: 1922

4. Purpose of Club: () Social () Recreational () Patriotic () Fraternal

5. Date regular meetings are held: 2nd Thursday of each month

6. Date of election of Club Officers: November 11, 2010

7. Date elected officers are installed: same

8. Total Membership: 384 Annual Dues: \$1,074,000 Payable When: October 1, 2010

9. Does the Club cater to the public or to groups of non-members on the premises? () YES () NO

10. Excluding salaries, will any person other than the Club, receive any of the financial profits from the sale of liquor?
() YES () NO

11. If a manager or steward is employed, complete the following:

Name: Robyn Violette Date of Birth: 1/8/1968

Daniel S. Redmond President
Signature and Title of Club Officer

Daniel S. Redmond President
Print Name and Title of Club Officer

**MAINE DEPT OF
PUBLIC SAFETY**

STATE OF MAINE
Liquor Licensing & Inspection Division
164 State House Station
Augusta ME 04333-0164
Tel: (207) 624-7220 Fax: (207) 287-3424



SUPPLEMENTARY QUESTIONNAIRE FOR CLUB APPLICANTS

1. Exact Club Name: Fullpaddock Club

2. Title, name, birth date and telephone number of each principal officer of the club:

Title	Name	Birth Date	Telephone
President	Daniel Redmond	10/16/1946	(207) 767-4198
Vice-President	Susan Abraham	10/25/1959	(207) 799-7640
Treasurer	James O'Conna	2/10/1958	(207) 799-9071

3. Date Club was incorporated: 1922

4. Purpose of Club: () Social () Recreational () Patriotic () Fraternal

5. Date regular meetings are held: 2nd Thursday of each month

6. Date of election of Club Officers: November 11, 2010

7. Date elected officers are installed: November 11, 2010

8. Total Membership: _____ Annual Dues: _____ Payable When: October 1, 2010

9. Does the Club cater to the public or to groups of non-members on the premises? Yes No

10. Excluding salaries, will any person, other than the Club, receive any of the financial profits from the sales of liquors? Yes No

11. If a manager or steward is employed, complete the following:

Name: Robyn Violette Date of Birth: 1/8/1968

Sign in blue ink

Daniel S Redmond President
Signature & Title of Club Officer

12/1/2010
Date

Daniel S. Redmond President
Print Name & Title of Club Officer

SECOND FLOOR KEY PLAN
ROAD 17A 17B 17C

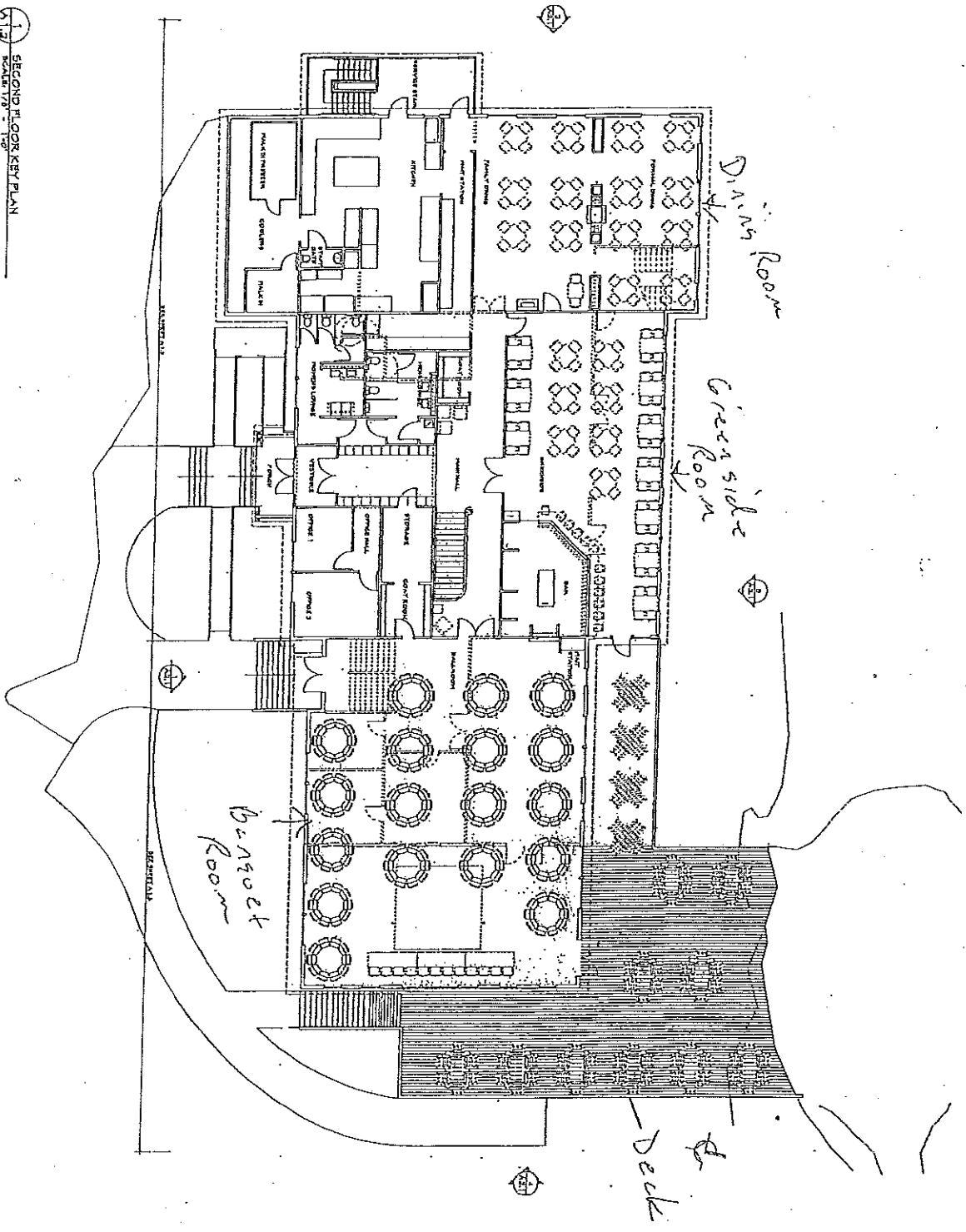

THIS DRAWING IS AN INSTRUMENT OF SERVICE AND SHALL REMAIN THE PROPERTY OF THE ARCHITECTS. IT SHALL NOT BE REPRODUCED, COPIED, OR TRANSMITTED IN ANY FORM OR BY ANY MEANS, ELECTRONIC OR MECHANICAL, WITHOUT THE WRITTEN PERMISSION OF THE ARCHITECTS.

A1.2	1/2" = 1'-0" 1/4" = 1'-0" 1/8" = 1'-0" 1/16" = 1'-0" 1/32" = 1'-0" 1/64" = 1'-0" 1/128" = 1'-0" 1/256" = 1'-0" 1/512" = 1'-0" 1/1024" = 1'-0" 1/2048" = 1'-0" 1/4096" = 1'-0" 1/8192" = 1'-0" 1/16384" = 1'-0" 1/32768" = 1'-0" 1/65536" = 1'-0" 1/131072" = 1'-0" 1/262144" = 1'-0" 1/524288" = 1'-0" 1/1048576" = 1'-0" 1/2097152" = 1'-0" 1/4194304" = 1'-0" 1/8388608" = 1'-0" 1/16777216" = 1'-0" 1/33554432" = 1'-0" 1/67108864" = 1'-0" 1/134217728" = 1'-0" 1/268435456" = 1'-0" 1/536870912" = 1'-0" 1/1073741824" = 1'-0" 1/2147483648" = 1'-0" 1/4294967296" = 1'-0" 1/8589934592" = 1'-0" 1/17179869184" = 1'-0" 1/34359738368" = 1'-0" 1/68719476736" = 1'-0" 1/137438953472" = 1'-0" 1/274877906944" = 1'-0" 1/549755813888" = 1'-0" 1/1099511627776" = 1'-0" 1/2199023255552" = 1'-0" 1/4398046511104" = 1'-0" 1/8796093022208" = 1'-0" 1/17592186044416" = 1'-0" 1/35184372088832" = 1'-0" 1/70368744177664" = 1'-0" 1/140737488355328" = 1'-0" 1/281474976710656" = 1'-0" 1/562949953421312" = 1'-0" 1/1125899906842624" = 1'-0" 1/2251799813685248" = 1'-0" 1/4503599627370496" = 1'-0" 1/9007199254740992" = 1'-0" 1/18014398509481984" = 1'-0" 1/36028797018963968" = 1'-0" 1/72057594037927936" = 1'-0" 1/144115188075855872" = 1'-0" 1/288230376151711744" = 1'-0" 1/576460752303423488" = 1'-0" 1/1152921504606846976" = 1'-0" 1/2305843009213693952" = 1'-0" 1/4611686018427387904" = 1'-0" 1/9223372036854775808" = 1'-0" 1/18446744073709551616" = 1'-0" 1/36893488147419103232" = 1'-0" 1/73786976294838206464" = 1'-0" 1/147573952589676412928" = 1'-0" 1/295147905179352825856" = 1'-0" 1/590295810358705651712" = 1'-0" 1/1180591620717411303424" = 1'-0" 1/2361183241434822606848" = 1'-0" 1/4722366482869645213696" = 1'-0" 1/9444732965739290427392" = 1'-0" 1/18889465931478580854784" = 1'-0" 1/37778931862957161709568" = 1'-0" 1/75557863725914323419136" = 1'-0" 1/151115727451828646838272" = 1'-0" 1/302231454903657293676544" = 1'-0" 1/604462909807314587353088" = 1'-0" 1/1208925819614629174706176" = 1'-0" 1/2417851639229258349412352" = 1'-0" 1/4835703278458516698824704" = 1'-0" 1/9671406556917033397649408" = 1'-0" 1/19342813113834066795298816" = 1'-0" 1/38685626227668133590597632" = 1'-0" 1/77371252455336267181195264" = 1'-0" 1/154742504910672534362390528" = 1'-0" 1/309485009821345068724781056" = 1'-0" 1/618970019642690137449562112" = 1'-0" 1/1237940039285380274899124224" = 1'-0" 1/2475880078570760549798248448" = 1'-0" 1/4951760157141521099596496896" = 1'-0" 1/9903520314283042199192993792" = 1'-0" 1/19807040628566084398385987584" = 1'-0" 1/39614081257132168796771975168" = 1'-0" 1/79228162514264337593543950336" = 1'-0" 1/158456325028528675187087900672" = 1'-0" 1/316912650057057350374175801344" = 1'-0" 1/633825300114114700748351602688" = 1'-0" 1/1267650600228229401496703205376" = 1'-0" 1/2535301200456458802993406410752" = 1'-0" 1/5070602400912917605986812821504" = 1'-0" 1/10141204801825835211973625643008" = 1'-0" 1/20282409603651670423947251286016" = 1'-0" 1/40564819207303340847894502572032" = 1'-0" 1/81129638414606681695789005144064" = 1'-0" 1/162259276832213363391578010288128" = 1'-0" 1/324518553664426726783156020576256" = 1'-0" 1/649037107328853453566312041152512" = 1'-0" 1/1298074214657707107132624082305024" = 1'-0" 1/2596148429315414214265248164610048" = 1'-0" 1/5192296858630828428530496329220096" = 1'-0" 1/10384593717261656857060992658440192" = 1'-0" 1/20769187434523313714121985316880384" = 1'-0" 1/41538374869046627428243970633760768" = 1'-0" 1/83076749738093254856487941267521536" = 1'-0" 1/166153499476186509712975882535042752" = 1'-0" 1/332306998952373019425951765070085504" = 1'-0" 1/664613997904746038851903530140171008" = 1'-0" 1/1329227995809492077703807060283422016" = 1'-0" 1/2658455991618984155407614120566844032" = 1'-0" 1/5316911983237968310815228241133688064" = 1'-0" 1/10633823966475936621630456482267376128" = 1'-0" 1/21267647932951873243260912964534752256" = 1'-0" 1/4253529586590374648652182592906950512" = 1'-0" 1/8507059173180749297304365185813901024" = 1'-0" 1/17014118346361498594608730371627802048" = 1'-0" 1/34028236692722997189217460743255604096" = 1'-0" 1/68056473385445994378434921486511208192" = 1'-0" 1/136112946770891988756869842973022416384" = 1'-0" 1/272225893541783977513739685946044832768" = 1'-0" 1/544451787083567955027479371892089665536" = 1'-0" 1/1088903574167135910054958743784179131072" = 1'-0" 1/2177807148334271820109917487568358262144" = 1'-0" 1/4355614296668543640219834975136716524288" = 1'-0" 1/8711228593337087280439669950273433048576" = 1'-0" 1/1742245718667417456087933890046666609712" = 1'-0" 1/34844914373348349121758677800933333215424" = 1'-0" 1/69689828746696698243517355601866666430848" = 1'-0" 1/139379657493393396487034711203733332861696" = 1'-0" 1/278759314986786792974069422407466665723328" = 1'-0" 1/5575186299735735859481388448149333311446656" = 1'-0" 1/111503725994714717189627769762966662291312" = 1'-0" 1/223007451989429434379255539525933334582624" = 1'-0" 1/446014903978858868758511079041186669165248" = 1'-0" 1/892029807957717737517022158083733383330496" = 1'-0" 1/1784059615915435475034044361674666666609984" = 1'-0" 1/3568119231830870950068088723353333333219968" = 1'-0" 1/713623846366174190013617644670666666439936" = 1'-0" 1/1427247692732348380027235289341333332879872" = 1'-0" 1/2854495385464696760054470578682666657599648" = 1'-0" 1/5708990770929393520108941157365333315119936" = 1'-0" 1/1141798154185878704021788231471066630239872" = 1'-0" 1/2283596308371757408043576462942133360479744" = 1'-0" 1/4567192616743514816087152925884266612095936" = 1'-0" 1/9134385233487029632174305851768533324191872" = 1'-0" 1/18268770466974059264348611703536666483833744" = 1'-0" 1/36537540933948118528697223407073339677667888" = 1'-0" 1/73075081867896237057394446814146669355335776" = 1'-0" 1/146150163735792474114788893628293387110671552" = 1'-0" 1/29230032747158494822957778725658677422134304" = 1'-0" 1/58460065494316989645915557451317354844268608" = 1'-0" 1/11692013098863397929183111490263468868853216" = 1'-0" 1/23384026197726795858366222980526937337706432" = 1'-0" 1/46768052395453591716732445961053874675412864" = 1'-0" 1/93536104790907183433464891922107749350825728" = 1'-0" 1/18707220958181436686692978384421549870165456" = 1'-0" 1/37414441916362873373385956768843099740330912" = 1'-0" 1/74828883832725746746771913537686199480661824" = 1'-0" 1/14965776766545149493354382707537239896132648" = 1'-0" 1/29931553533090298986708765415074479792265296" = 1'-0" 1/59863107066180597973417530830148959584530592" = 1'-0" 1/119726214132361195946835061660297991170611184" = 1'-0" 1/23945242826472239189367012332059598234122368" = 1'-0" 1/47890485652944478378734024664119196468244736" = 1'-0" 1/95780971305888956757468049328238392936489472" = 1'-0" 1/191561942611777913514936098656476785872978448" = 1'-0" 1/383123885223555827029872197312953571755956896" = 1'-0" 1/766247770447111654059744394625907135111913792" = 1'-0" 1/153249554089422330811948878925181427022383584" = 1'-0" 1/30649910817884466162389775785036285404476768" = 1'-0" 1/61299821635768932324779551570072570808953536" = 1'-0" 1/122599643271537864649559103140145141617907072" = 1'-0" 1/245199286543075729299118206280290283235814144" = 1'-0" 1/490398573086151458598236412560580566471628288" = 1'-0" 1/980797146172302917196472825121161132943256576" = 1'-0" 1/1961594292344605834392945650242322265886531552" = 1'-0" 1/392318858468921166878589130048464453177306304" = 1'-0" 1/784637716937842333757178260096928906354612608" = 1'-0" 1/1569275433875684667514356520193857812709225216" = 1'-0" 1/313855086775136933502871304038771545441844432" = 1'-0" 1/62771017355027386700574260807754309088368864" = 1'-0" 1/125542034710054773401148521615508618176737728" = 1'-0" 1/251084069420109546802297043231017236353475456" = 1'-0" 1/50216813884021909360459408646203457270695104" = 1'-0" 1/100433627768043818720918817292406914541390208" = 1'-0" 1/200867255536087637441837634584813829082780416" = 1'-0" 1/401734511072175274883674689169627658165560832" = 1'-0" 1/803469022144350549767349378339255316331121664" = 1'-0" 1/160693804428870109953469875667510662666243328" = 1'-0" 1/32138760885774021990693975133502133333266656" = 1'-0" 1/64277521771548043981387950267004266665333112" = 1'-0" 1/12855504354309608796277590053400853333066624" = 1'-0" 1/25711008708619217592555180106801706666133248" = 1'-0" 1/51422017417238435185110360213603413332666496" = 1'-0" 1/102844034834476870370220720427206826665333984" = 1'-0" 1/205688069668953740740441440854413653330667968" = 1'-0" 1/411376139337907481480882881708827306661335936" = 1'-0" 1/82275227867581496296176576341765461333267184" = 1'-0" 1/16455045573516299259235315268353092666534368" = 1'-0" 1/32910091147032598518470630536706185333068736" = 1'-0" 1/65820182294065197036941261073412370666137744" = 1'-0" 1/131640364588130394073882522146824741333275488" = 1'-0" 1/263280729176260788147765044293649482666550976" = 1'-0" 1/526561458352521576295530088587298965333101952" = 1'-0" 1/105312291670504315259106017717459793066203904" = 1'-0" 1/210624583341008630518212035434919586132407808" = 1'-0" 1/421249166682017261036424070869839172264815616" = 1'-0" 1/842498333364034522072848141739678344529631232" = 1'-0" 1/1684996667328069044145762835479366889059262464" = 1'-0" 1/3369993334656138088291525670958733778118524928" = 1'-0" 1/673998666931227617658305134191746755623704976" = 1'-0" 1/1347997333862455235316610282383493511247409952" = 1'-0" 1/2695994667724910470633220564766987022494819904" = 1'-0" 1/539198933544982094126644112953397404498959808" = 1'-0" 1/107839786708996418825328822590679480899799616" = 1'-0" 1/215679573417992837650657645181358961799599232" = 1'-0" 1/431359146835985675301315290362717923599198464" = 1'-0" 1/862718293671971350602630580725435847198396928" = 1'-0" 1/1725436587343942701205261161450871694396793856" = 1'-0" 1/3450873174687885402410522322901743288793587712" = 1'-0" 1/6901746349375770804821044645803486577587175424" = 1'-0" 1/138034926987515416096420892916069731551754848" = 1'-0" 1/276069853975030832192841785832139463103508896" = 1'-0" 1/552139707950061664385683571664278926207017792" = 1'-0" 1/110427941590012332877136714332855785241403584" = 1'-0" 1/220855883180024665754273428665711574882807168" = 1'-0" 1/44171176636004933150854685733142314977614336" = 1'-0" 1/88342353272009866301709371466284629955228704" = 1'-0" 1/176684706544019732603418742932569259910457408" = 1'-0" 1/353369413088039465206837485865138519820914816" = 1'-0" 1/70673882617607893041367491773027703964182832" = 1'-0" 1/141347765235215786082734983546055407928365664" = 1'-0" 1/282695530470431572165469967092110815856731328" = 1'-0" 1/56539106094086314433093993418422161711346256" = 1'-0" 1/113078212188172628866187986836844323422692512" = 1'-0" 1/226156424376345257732375973673688646845385024" = 1'-0" 1/452312848752690515464751947347377293710770448" = 1'-0" 1/90462569750538103092950389469475458742154096" = 1'-0" 1/180925139501076206185900778938950917484308192" = 1'-0" 1/361850279002152412371801557877901829688616384" = 1'-0" 1/723700558004304824743603115755803659377232768" = 1'-0" 1/144740111600860944948720623551160711875445536" = 1'-0" 1/289480223201721889897441247102321437510891072" = 1'-0" 1/57896044640344377979488249420464287502178144" = 1'-0" 1/1157920892806887559589764988409285700043568" = 1'-0" 1/2315841785613775119179529976818571400087136" = 1'-0" 1/463168357122755023835905995363714200174272" = 1'-0" 1/926336714245510047671811990727428400348544" = 1'-0"
-------------	---



Town Clerk's Office
P.O. Box 6260
Cape Elizabeth, Maine 04107
799-7665

pa \$10.00 12/2/10
cb # 34262

**APPLICATION FOR SPECIAL AMUSEMENT PERMIT FOR
DANCING AND ENTERTAINMENT**

A \$10.00 fee must accompany the completed application.

BUSINESS NAME Furwoodock Club

ADDRESS 300 Sadrwick Avenue
Cape Elizabeth, Me. 04107

Describe in detail the kind and nature of entertainment:
Club, banquet facility

Describe in detail the room or rooms that will be used under this permit:
Dining room and banquet room

Dated at Cape Elizabeth On December 2 2010

This permit includes all types of entertainment, dancing is inclusive only if you have a dancing license issued by the State Fire Marshall's Office, Department of Public Safety.

Daniel S. Redmond
Signature of Individual

If partnership, by members

Furwoodock Club
Name of Corporation

PLACE CORPORATE SEAL

By Daniel S. Redmond
If a Corporation, by a duly authorized officer

STATE OF MAINE

ss

Dated at _____, Maine On _____ 20__

The undersigned being Municipal Officers of the Town of Cape Elizabeth hereby approve the application in accordance with the provisions of Section, 702 of Title 28, Maine Revised Statutes, 1964.

